

DRC

PZ23-12000032  
02/19/2025

SHEET INDEX:

|               |                             |
|---------------|-----------------------------|
| 009 L-1       | LANDSCAPE SITE PLAN         |
| 009.2 L-2     | EXISTING LANDSCAPE PLAN     |
| 009.3 L-3     | EXISTING LANDSCAPE PLAN     |
| 009.4 L-4     | EXISTING LANDSCAPE PLAN     |
| 009.4.1 L-4.1 | EXISTING LANDSCAPE PLAN     |
| 009.4.2 L-4.2 | EXISTING LANDSCAPE PLAN     |
| 009.5 L-5     | EXISTING LANDSCAPE SCHEDULE |
| 009.6 L-6     | PROPOSED LANDSCAPE PLAN     |
| 009.7 L-7     | PROPOSED LANDSCAPE PLAN     |
| 009.8 L-8     | PROPOSED LANDSCAPE PLAN     |
| 009.8.1 L-8.1 | PROPOSED LANDSCAPE PLAN     |
| 009.8.2 L-8.2 | PROPOSED LANDSCAPE PLAN     |
| 009.9 L-9     | PROPOSED LANDSCAPE SCHEDULE |
| 009.9.1 L-10  | LANDSCAPE SPECIFICATIONS    |

DRC  
PZ23-12000032  
12/04/2024

Bonissati Turn Lane  
10 NW 18th St  
Pompano Beach, FL 33069



Krent L. Wieland  
2024.10.15  
11:35:33 -04'00'

09/26/24 City Comments  
05/17/24 City Comments  
ISSUE HISTORY  
PROJ NO: 23034A  
PROJ MGR: DC  
DRAWN BY: DC  
CHECKED BY: KWD

DRAWING TITLE:  
**Landscape  
Site  
Plan**

SHEET:  
**009 L-1**

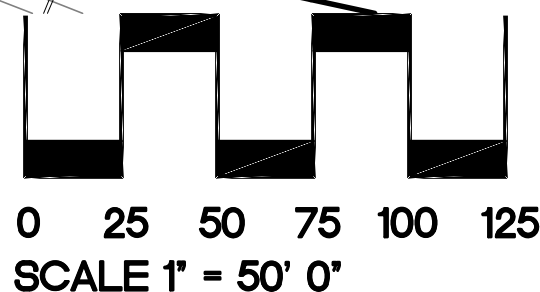

SUBMISSION  
09/26/24

NOT FOR CONSTRUCTION

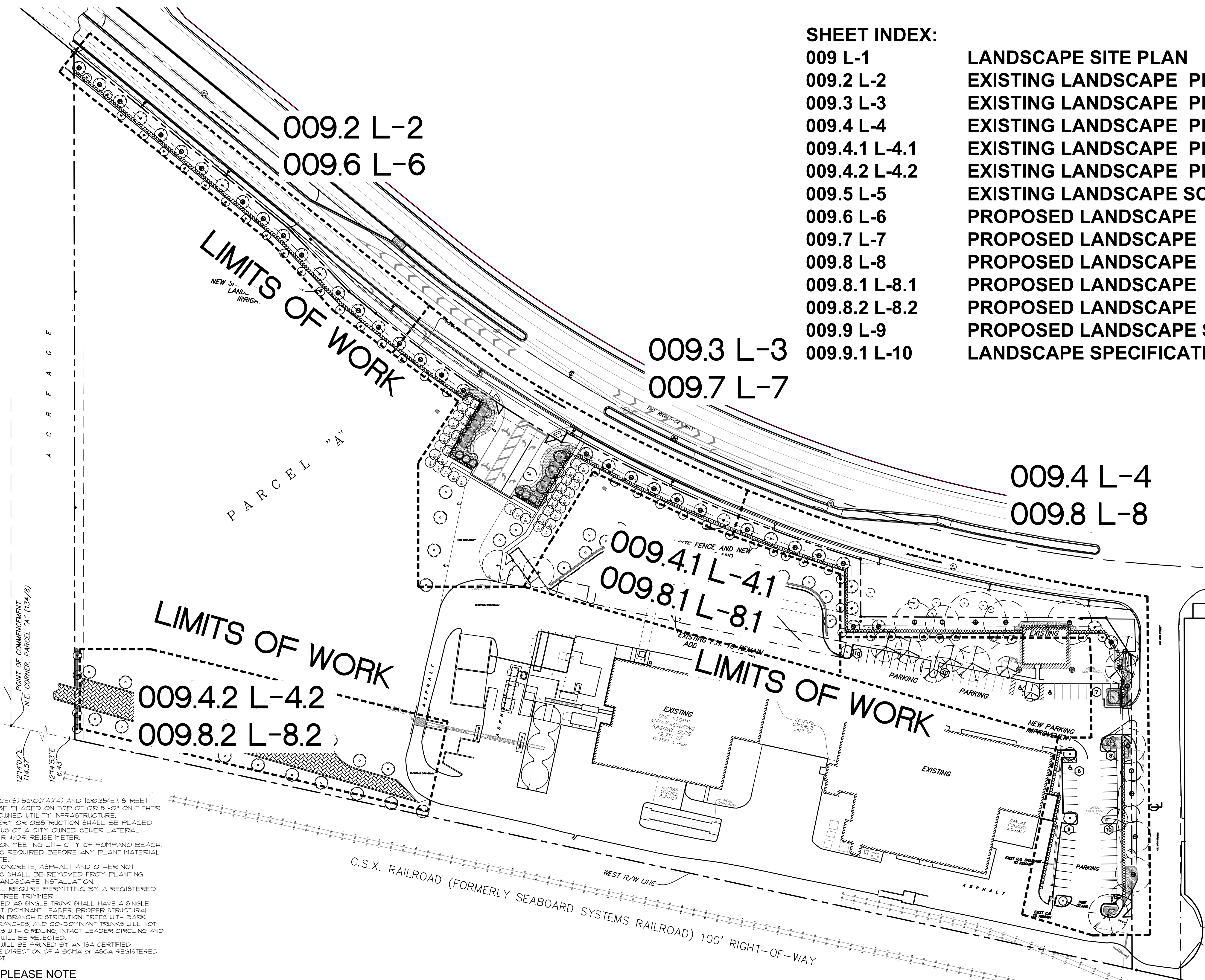

NOTES:

- 1) PER CITY ORDINANCE(S) 50.02(A)(4) AND 100.35(E), STREET TREES SHALL NOT BE PLACED ON TOP OF OR 5'-0" ON EITHER SIDE OF ANY CITY OWNED UTILITY INFRASTRUCTURE.
- 2) NO TREES, SHRUBBERY OR OBSTRUCTION SHALL BE PLACED WITHIN A 3'-0" RADIUS OF A CITY OWNED SEWER LATERAL CLEANOUT OR WATER 4" OR REUSE METER.
- 3) A PRE-CONSTRUCTION MEETING WITH CITY OF POMPAÑO BEACH, URBAN FORESTRY, IS REQUIRED BEFORE ANY PLANT MATERIAL IS INSTALLED ON SITE.
- 4) ALL ROAD ROCK, CONCRETE, ASPHALT AND OTHER NOT NATURAL MATERIALS SHALL BE REMOVED FROM PLANTING AREAS PRIOR TO LANDSCAPE INSTALLATION.
- 5) ALL TREE WORK WILL REQUIRE PERMITTING BY A REGISTERED BROWARD COUNTY TREE TRIMMER.
- 6) ALL TREES DESIGNATED AS SINGLE TRUNK SHALL HAVE A SINGLE, RELATIVELY STRAIGHT, DOMINANT LEADER, PROPER STRUCTURAL BRANCHING AND EVEN BRANCH DISTRIBUTION. TREES WITH BARK INCLUSION, TIPPED BRANCHES, AND CO-DOMINANT TRUNKS WILL NOT BE ACCEPTED. TREES WITH GIRDLING, INTACT LEADER CIRCLING AND OR PLUNGING ROOTS WILL BE REJECTED.
- 7) ALL EXISTING TREES WILL BE PRUNED BY AN ISA CERTIFIED ARBORIST UNDER THE DIRECTION OF A BCMA or ASCA REGISTERED CONSULTING ARBORIST.

CAUTION: PLEASE NOTE

Contractor shall secure all permits required for the work from any state or local departments, utility companies or jurisdiction affected by the work. The Contractor shall have permits "in hand" prior to starting work. The Landscape Architect and/or Owner shall bear no responsibility for work performed without permitted drawings. The Contractor shall be responsible for all changes to work, at no additional cost to Owner, as a result of unauthorized work prior to receipt of permit.

This drawing is an instrument of service, copyright © 1984-2024 by Krent Wieland Design, Inc., d/b/a KWD Landscape Architecture. All rights reserved - Not to be reproduced in part or in whole without express written permission. Florida Registration LA 1039.